

⚠ Please read prior to installation

Ensure there is the appropriate number of bodies or machinery on-site to safely unload and lift the unit.

The rooflight will arrive in a timber crate for protection. We recommend you keep the rooflight in the crate until the later stages of the installation process.

You must inspect the rooflight for any damage that may have occurred in transport and report to your supplier within 24 hours of delivery.

You must handle the unit with extreme care and caution. The appropriate PPE should be adopted when handling glass.

This rooflight is not suitable as a walk-on glass unit, i.e. not rated for foot traffic.

All building project requirements are unique, it is therefore the client's ultimate responsibility to ensure that the clearly stated specification of the skylight is suitable for the specific build. The skylight must be installed safely and in accordance with the relevant planning authority, structural requirements, and building and safety regulations.



Scan QR code for Installation Video
& Technical Drawings

Or visit www.sunviewrooflights.co.uk/frameless-install

What's included with your purchase?



1x FL2 Frameless Rooflight



1x Easy Fit Timber Kerb



1x Installation Pack, which includes

1x Glazing Tape, 1x Pack of Fixings Screws, SOUDAL Low Modulus Sealant

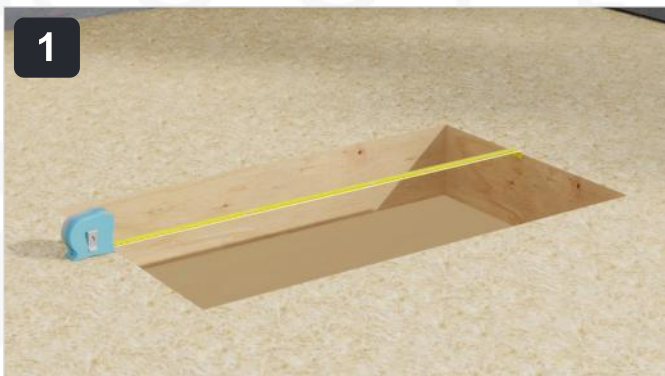

1

Verify all measurements are correct. The stated rooflight size should be the same as the structural opening size, i.e. the hole in your roof size.

See technical drawings for more information.



2

Construct your upstand. The customer-built upstand sits below our Easy Fit Timber Kerb. The upstand should be constructed to suit our 70mm x 70mm Easy Fit Timber Kerb. As per building regulations, the lowest point of the upstand should be 150mm high (including the Easy Fit Timber Kerb).



3



All rooflights must be installed with the correct fall of at least:

1:12 / 80:1000 / 5° per 1000mm

You must include a minimum fall in the upstand to avoid water pooling and increase the effectiveness of the self-clean coating.

We recommend a minimum gradient of 80mm per every 1000mm skylight size. This should run in line with the fall of the roof.

A simple water test should be carried out prior to installation by pouring water on to the highest point of the skylight and monitoring for pooling. If pooling does occur, a higher fall should be implemented.



4
Place the Easy Fit Kerb on top of the upstand. Ensure that the inside of the kerb is flush with the inside of the upstand.

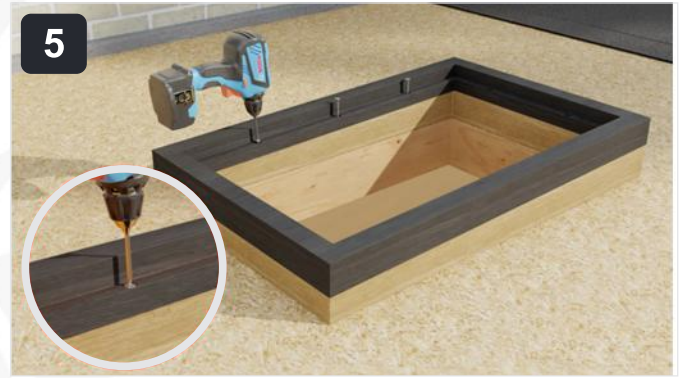

5
Use the provided fixing screws to fix the Easy Fit Kerb into the upstand. The fixing screws must be countersunk to ensure the screws do not protrude the kerb.



6
Apply your roof covering to weatherproof the upstand. Roof covering material type should be determined by the installer. Roof covering should not overlap the top of the kerb.



7
Apply glazing tape. The glazing tape should be applied to the inside kerb rebate and should fully cover the fixing screws.



8
Apply low modulus sealant. Apply a generous, continuous bead of sealant to the top of the Easy Fit Kerb.



9
Lift skylight into place. Ensure there is enough people to safely support the skylight and carefully lift the skylight into place.



10
Apply low modulus sealant. Apply another bead of sealant to the underside of the rooflight.



Installation Complete!